

THE WOOD RIDGE

1,344 SQ. FEET

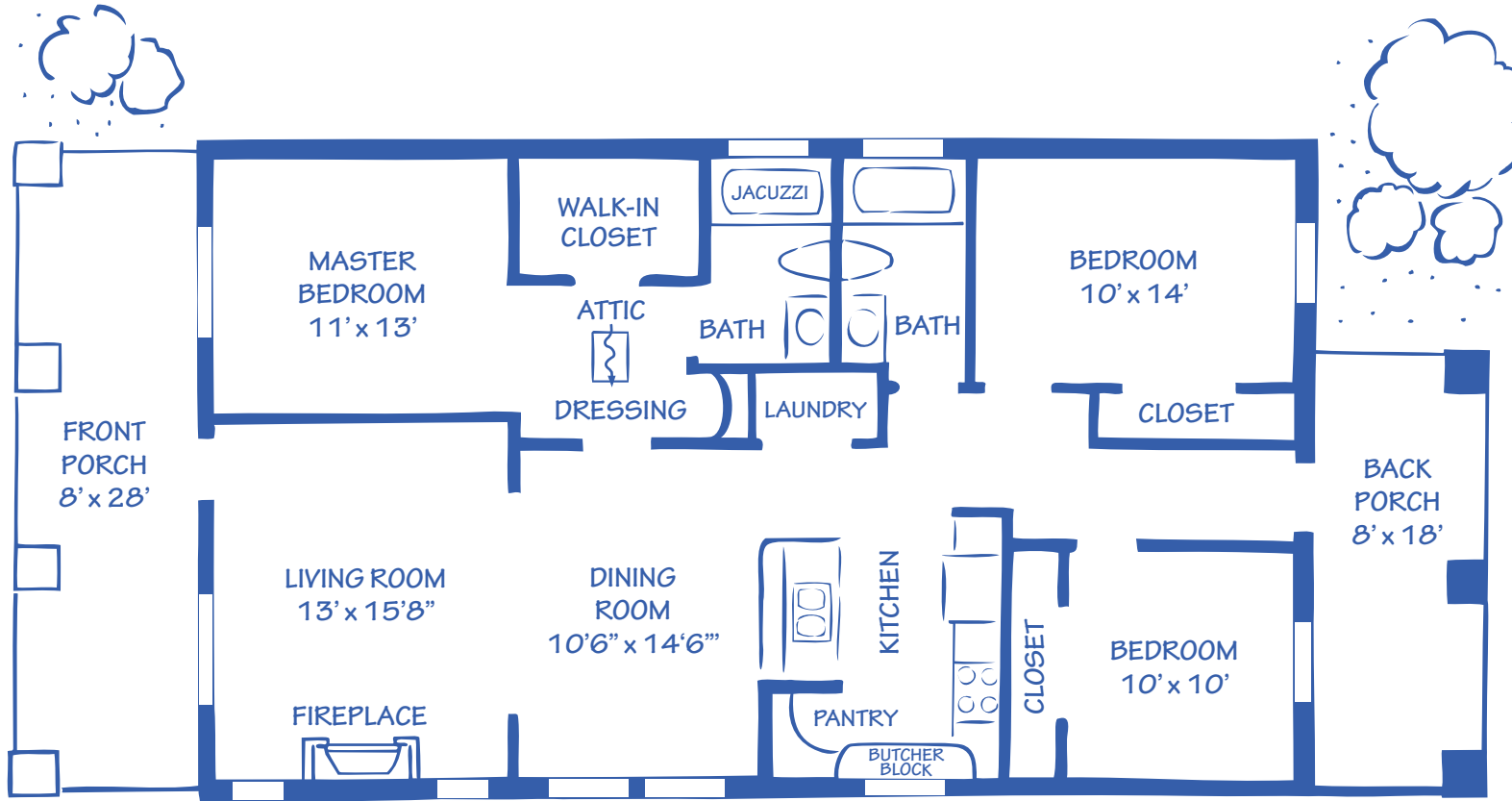

129 GRANITE RIDGE CIRCLE

3 bedroom 2 bath

Crisp white custom woodwork includes elegant signature arches through out this easy flow executive design. White trim and corbels framing red brick, with architectural shingles over the slate front porch. Matching two car garage.

- Long sight lines and great views of the mountains.
- Dark solid wood floor and solid oak doors contrast.
- Easy entertaining from a heart beat kitchen.
- Smart kitchen has stainless steel appliances.
- Large Master Suite boasts walk in closet.
- Central laundry area w/ storage & stone counter top.
- 2nd and 3rd bedrooms flank back hallway.
- The extensive cobblestone walls, slate covered stairs, and landscaped yard make the Wood Ridge a welcoming home in the Granite Ridge area.
- Immediate access to soon to be completed nature walking trail system.
- Includes 1 year Builder Warranty & Buyer Orientation

Completed: May 31, 2008

Built by David McCoy, Certified Builder
Board Member of Lawton Home Builders Association,
Member of the National Home Builders Association

TITLE GRANITE RIDGE
MEDICINE PARK

DATE 2008

PLAN THE WOOD RIDGE

DESIGNER CANDACE McCOY

BUILDER DAVID McCOY